



# ADTO GROUP

## 湖南元拓实业集团有限公司



# Rebar Connection System

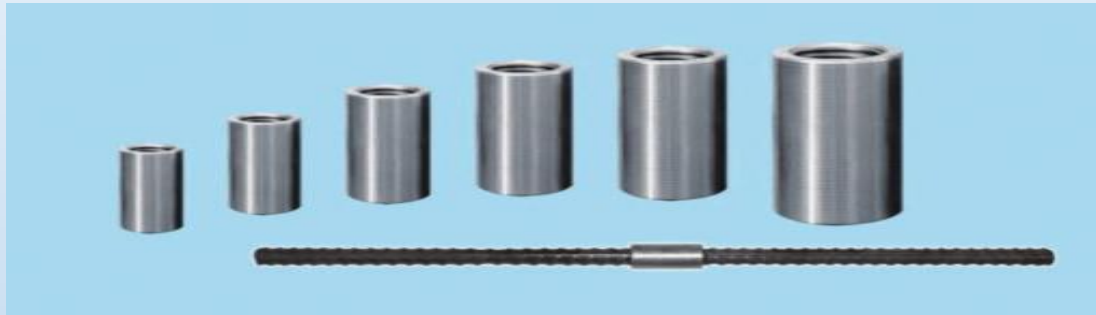

ADTO Group is established in 1998, Headquarters is located in Changsha ,Hunan, Rebar coupler factory in Shang dong province.

Our company has strong technical force and mechanical laboratory, which has passed ISO9001 international quality system certification. And the annual output of mechanical equipment is over 3 million sets, rebar coupler are more than 10 million. Our mechanical joints all passed inspection, the tensile strength, secant modulus, ultimate stress and residual deformation this four indicators all can meet the requirements of the standard of the Ministry of construction of China (JGJ107-2016) for class I and class II joints, also meet the U.S. standard (UBC1997), British Standard (bs8110), German standard (din1045) and other foreign standards for SA level and A-level joints. And there are applicable to the mechanical connection of HRB335 and HRB500 bars in the foundation, beam column, slab, wall and other structures of reinforced concrete structures in a large number of civil, industrial, tunnel, bridge, nuclear power, water conservancy, subway and various buildings.

And our company is approved by the industry with good faith Strength and product quality. The product is sold to China and around the world every year such as Dubai, Brazil, Korea, Vietnam and other more than 30 countries and regions. We firmly believe that we will win a better tomorrow as long as the market –oriented innovation-driven, quality –based and development –oriented growth.

We believe that our products will connect to the world



# Certification Of Company

ISO

CE FOR Machine

CE FOR Rebar coupler

ISO9001



**QUALITY MANAGEMENT  
SYSTEM CERTIFICATE**

Certificate No.: 04016Q13666R0M

We hereby certify that the organization:  
**Changsha Xiangjia Metal Material  
Trading Co., Ltd.**  
Unified social credit code: 914301117700857925



is in conformity with Quality Management System Standard:  
**GB/T19001-2016 / ISO9001:2015**

The certificate is valid to the following product(s)/service:  
**Selling of Steel Products and Hardware**

Registration Address/ Physical Address: Room 1605-1609, Mingcheng International  
Building, No. 46, Renmin East Road, Yuhua District, Changsha City, Hunan  
Province, P. R. China

  
Issued By

Date of Issue: 2016-10-19  
Date of Reissue: 2018-10-27  
Date of Expiry: 2019-10-18



The effectiveness of the  
Measurement can be  
checked on the CNCA website



**Beijing Head Inte**  
Address: Room 1801, Building 5, No. 19, B1

**ISET s.r.l.**  
Istituto Servizi  
Europei TECNOLOGICI

Sette Legate s. r.l.  
Via Donatori di Sangue, 5 - 40024 Bologna (BO)  
Tel. +39 051 23751000  
info@iset.it  
www.iset.it

Cap. 500.000.000  
Cod. Fiscale 01554740101  
Reg. Imprese  
MI 0237099

**CERTIFICATE OF COMPLIANCE**  
Certificado de Conformidade - Сертификат соответствия - Konformitätserklärung

1) **APPLICANT:**  
Changsha Xiangjia Metal Material Trading Co., Ltd.  
Room 1605-1609, Mingcheng International Building,  
No. 46 Renmin East Road,  
Changsha, Hunan, China

2) **CERTIFICATE NO.:**  
IT021406JD160701S  
**TCF(S) NO.:**  
TCF(10)-236-MD/LVD

3) **WITH REFERENCE TO EC DIRECTIVE APPLIED:**  
Machinery Directive 2006/42/EC  
Low Voltage Directive 2014/35/EU

4) **CERTIFICATION ISET MARK:**  

**HARMONIZED STANDARDS APPLIED:**  
EN ISO 12100:2010,  
EN 60204-1:2006/AC:2010

5) **PRODUCT CHARACTERISTICS:** Rebar Thread Rolling Machine  
**MODELS:** JBG-40A, JBG-40B, JBG-40C, JBG-40D, JBG-40E,  
JBG-40F, JBG-40G, JBG-40H, JBG-40I, JBG-40J, JBG-40K, JBG-40L, JBG-40M, JBG-40N, JBG-40O, JBG-40P, JBG-40Q, JBG-40R, JBG-40S, JBG-40T, JBG-40U, JBG-40V, JBG-40W, JBG-40X, JBG-40Y, JBG-40Z, JBG-40AA, JBG-40AB, JBG-40AC, JBG-40AD, JBG-40AE, JBG-40AF, JBG-40AG, JBG-40AH, JBG-40AI, JBG-40AJ, JBG-40AK, JBG-40AL, JBG-40AM, JBG-40AN, JBG-40AO, JBG-40AP, JBG-40AQ, JBG-40AR, JBG-40AS, JBG-40AT, JBG-40AU, JBG-40AV, JBG-40AW, JBG-40AX, JBG-40AY, JBG-40AZ, JBG-40BA, JBG-40BB, JBG-40BC, JBG-40BD, JBG-40BE, JBG-40BF, JBG-40BG, JBG-40BH, JBG-40BI, JBG-40BJ, JBG-40BK, JBG-40BL, JBG-40BM, JBG-40BN, JBG-40BO, JBG-40BP, JBG-40BQ, JBG-40BR, JBG-40BS, JBG-40BT, JBG-40BU, JBG-40BV, JBG-40BW, JBG-40BX, JBG-40BY, JBG-40BZ, JBG-40CA, JBG-40CB, JBG-40CC, JBG-40CD, JBG-40CE, JBG-40CF, JBG-40CG, JBG-40CH, JBG-40CI, JBG-40CJ, JBG-40CK, JBG-40CL, JBG-40CM, JBG-40CN, JBG-40CO, JBG-40CP, JBG-40CQ, JBG-40CR, JBG-40CS, JBG-40CT, JBG-40CU, JBG-40CV, JBG-40CW, JBG-40CX, JBG-40CY, JBG-40CZ, JBG-40DA, JBG-40DB, JBG-40DC, JBG-40DD, JBG-40DE, JBG-40DF, JBG-40DG, JBG-40DH, JBG-40DI, JBG-40DJ, JBG-40DK, JBG-40DL, JBG-40DM, JBG-40DN, JBG-40DO, JBG-40DP, JBG-40DQ, JBG-40DR, JBG-40DS, JBG-40DT, JBG-40DU, JBG-40DV, JBG-40DW, JBG-40DX, JBG-40DY, JBG-40DZ, JBG-40EA, JBG-40EB, JBG-40EC, JBG-40ED, JBG-40EE, JBG-40EF, JBG-40EG, JBG-40EH, JBG-40EI, JBG-40EJ, JBG-40EK, JBG-40EL, JBG-40EM, JBG-40EN, JBG-40EO, JBG-40EP, JBG-40EQ, JBG-40ER, JBG-40ES, JBG-40ET, JBG-40EU, JBG-40EV, JBG-40EW, JBG-40EX, JBG-40EY, JBG-40EZ, JBG-40FA, JBG-40FB, JBG-40FC, JBG-40FD, JBG-40FE, JBG-40FF, JBG-40FG, JBG-40FH, JBG-40FI, JBG-40FJ, JBG-40FK, JBG-40FL, JBG-40FM, JBG-40FN, JBG-40FO, JBG-40FP, JBG-40FQ, JBG-40FR, JBG-40FS, JBG-40FT, JBG-40FU, JBG-40FV, JBG-40FW, JBG-40FX, JBG-40FY, JBG-40FZ, JBG-40GA, JBG-40GB, JBG-40GC, JBG-40GD, JBG-40GE, JBG-40GF, JBG-40GG, JBG-40GH, JBG-40GI, JBG-40GJ, JBG-40GK, JBG-40GL, JBG-40GM, JBG-40GN, JBG-40GO, JBG-40GP, JBG-40GQ, JBG-40GR, JBG-40GS, JBG-40GT, JBG-40GU, JBG-40GV, JBG-40GW, JBG-40GX, JBG-40GY, JBG-40GZ, JBG-40HA, JBG-40HB, JBG-40HC, JBG-40HD, JBG-40HE, JBG-40HF, JBG-40HG, JBG-40HH, JBG-40HI, JBG-40HJ, JBG-40HK, JBG-40HL, JBG-40HM, JBG-40HN, JBG-40HO, JBG-40HP, JBG-40HQ, JBG-40HR, JBG-40HS, JBG-40HT, JBG-40HU, JBG-40HV, JBG-40HW, JBG-40HX, JBG-40HY, JBG-40HZ, JBG-40IA, JBG-40IB, JBG-40IC, JBG-40ID, JBG-40IE, JBG-40IF, JBG-40IG, JBG-40IH, JBG-40II, JBG-40IJ, JBG-40IK, JBG-40IL, JBG-40IM, JBG-40IN, JBG-40IO, JBG-40IP, JBG-40IQ, JBG-40IR, JBG-40IS, JBG-40IT, JBG-40IU, JBG-40IV, JBG-40IW, JBG-40IX, JBG-40IY, JBG-40IZ, JBG-40JA, JBG-40JB, JBG-40JC, JBG-40JD, JBG-40JE, JBG-40JF, JBG-40JG, JBG-40JH, JBG-40JI, JBG-40JJ, JBG-40JK, JBG-40JL, JBG-40JM, JBG-40JN, JBG-40JO, JBG-40JP, JBG-40JQ, JBG-40JR, JBG-40JS, JBG-40JT, JBG-40JU, JBG-40JV, JBG-40JW, JBG-40JX, JBG-40JY, JBG-40JZ, JBG-40KA, JBG-40KB, JBG-40KC, JBG-40KD, JBG-40KE, JBG-40KF, JBG-40KG, JBG-40KH, JBG-40KI, JBG-40KJ, JBG-40KL, JBG-40KM, JBG-40KN, JBG-40KO, JBG-40KP, JBG-40KQ, JBG-40KR, JBG-40KS, JBG-40KT, JBG-40KU, JBG-40KV, JBG-40KW, JBG-40KX, JBG-40KY, JBG-40KZ, JBG-40LA, JBG-40LB, JBG-40LC, JBG-40LD, JBG-40LE, JBG-40LF, JBG-40LG, JBG-40LH, JBG-40LI, JBG-40LJ, JBG-40LK, JBG-40LL, JBG-40LM, JBG-40LN, JBG-40LO, JBG-40LP, JBG-40LQ, JBG-40LR, JBG-40LS, JBG-40LT, JBG-40LU, JBG-40LV, JBG-40LW, JBG-40LX, JBG-40LY, JBG-40LZ, JBG-40MA, JBG-40MB, JBG-40MC, JBG-40MD, JBG-40ME, JBG-40MF, JBG-40MG, JBG-40MH, JBG-40MI, JBG-40MJ, JBG-40MK, JBG-40ML, JBG-40MM, JBG-40MN, JBG-40MO, JBG-40MP, JBG-40MQ, JBG-40MR, JBG-40MS, JBG-40MT, JBG-40MU, JBG-40MV, JBG-40MW, JBG-40MX, JBG-40MY, JBG-40MZ, JBG-40NA, JBG-40NB, JBG-40NC, JBG-40ND, JBG-40NE, JBG-40NF, JBG-40NG, JBG-40NH, JBG-40NI, JBG-40NJ, JBG-40NK, JBG-40NL, JBG-40NM, JBG-40NN, JBG-40NO, JBG-40NP, JBG-40NQ, JBG-40NR, JBG-40NS, JBG-40NT, JBG-40NU, JBG-40NV, JBG-40NW, JBG-40NX, JBG-40NY, JBG-40NZ, JBG-40OA, JBG-40OB, JBG-40OC, JBG-40OD, JBG-40OE, JBG-40OF, JBG-40OG, JBG-40OH, JBG-40OI, JBG-40OJ, JBG-40OK, JBG-40OL, JBG-40OM, JBG-40ON, JBG-40OO, JBG-40OP, JBG-40OQ, JBG-40OR, JBG-40OS, JBG-40OT, JBG-40OU, JBG-40OV, JBG-40OW, JBG-40OX, JBG-40OY, JBG-40OZ, JBG-40PA, JBG-40PB, JBG-40PC, JBG-40PD, JBG-40PE, JBG-40PF, JBG-40PG, JBG-40PH, JBG-40PI, JBG-40PJ, JBG-40PK, JBG-40PL, JBG-40PM, JBG-40PN, JBG-40PO, JBG-40PP, JBG-40PQ, JBG-40PR, JBG-40PS, JBG-40PT, JBG-40PU, JBG-40PV, JBG-40PW, JBG-40PX, JBG-40PY, JBG-40PZ, JBG-40QA, JBG-40QB, JBG-40QC, JBG-40QD, JBG-40QE, JBG-40QF, JBG-40QG, JBG-40QH, JBG-40QI, JBG-40QJ, JBG-40QK, JBG-40QL, JBG-40QM, JBG-40QN, JBG-40QO, JBG-40QP, JBG-40QQ, JBG-40QR, JBG-40QS, JBG-40QT, JBG-40QU, JBG-40QV, JBG-40QW, JBG-40QX, JBG-40QY, JBG-40QZ, JBG-40RA, JBG-40RB, JBG-40RC, JBG-40RD, JBG-40RE, JBG-40RF, JBG-40RG, JBG-40RH, JBG-40RI, JBG-40RJ, JBG-40RK, JBG-40RL, JBG-40RM, JBG-40RN, JBG-40RO, JBG-40RP, JBG-40RQ, JBG-40RR, JBG-40RS, JBG-40RT, JBG-40RU, JBG-40RV, JBG-40RW, JBG-40RX, JBG-40RY, JBG-40RZ, JBG-40SA, JBG-40SB, JBG-40SC, JBG-40SD, JBG-40SE, JBG-40SF, JBG-40SG, JBG-40SH, JBG-40SI, JBG-40SJ, JBG-40SK, JBG-40SL, JBG-40SM, JBG-40SN, JBG-40SO, JBG-40SP, JBG-40SQ, JBG-40SR, JBG-40SS, JBG-40ST, JBG-40SU, JBG-40SV, JBG-40SW, JBG-40SX, JBG-40SY, JBG-40SZ, JBG-40TA, JBG-40TB, JBG-40TC, JBG-40TD, JBG-40TE, JBG-40TF, JBG-40TG, JBG-40TH, JBG-40TI, JBG-40TJ, JBG-40TK, JBG-40TL, JBG-40TM, JBG-40TN, JBG-40TO, JBG-40TP, JBG-40TQ, JBG-40TR, JBG-40TS, JBG-40TT, JBG-40TU, JBG-40TV, JBG-40TW, JBG-40TX, JBG-40TY, JBG-40TZ, JBG-40UA, JBG-40UB, JBG-40UC, JBG-40UD, JBG-40UE, JBG-40UF, JBG-40UG, JBG-40UH, JBG-40UI, JBG-40UJ, JBG-40UK, JBG-40UL, JBG-40UM, JBG-40UN, JBG-40UO, JBG-40UP, JBG-40UQ, JBG-40UR, JBG-40US, JBG-40UT, JBG-40UU, JBG-40UV, JBG-40UW, JBG-40UX, JBG-40UY, JBG-40UZ, JBG-40VA, JBG-40VB, JBG-40VC, JBG-40VD, JBG-40VE, JBG-40VF, JBG-40VG, JBG-40VH, JBG-40VI, JBG-40VJ, JBG-40VK, JBG-40VL, JBG-40VM, JBG-40VN, JBG-40VO, JBG-40VP, JBG-40VQ, JBG-40VR, JBG-40VS, JBG-40VT, JBG-40VU, JBG-40VV, JBG-40VW, JBG-40VX, JBG-40VY, JBG-40VZ, JBG-40WA, JBG-40WB, JBG-40WC, JBG-40WD, JBG-40WE, JBG-40WF, JBG-40WG, JBG-40WH, JBG-40WI, JBG-40WJ, JBG-40WK, JBG-40WL, JBG-40WM, JBG-40WN, JBG-40WO, JBG-40WP, JBG-40WQ, JBG-40WR, JBG-40WS, JBG-40WT, JBG-40WU, JBG-40WV, JBG-40WW, JBG-40WX, JBG-40WY, JBG-40WZ, JBG-40XA, JBG-40XB, JBG-40XC, JBG-40XD, JBG-40XE, JBG-40XF, JBG-40XG, JBG-40XH, JBG-40XI, JBG-40XJ, JBG-40XK, JBG-40XL, JBG-40XM, JBG-40XN, JBG-40XO, JBG-40XP, JBG-40XQ, JBG-40XR, JBG-40XS, JBG-40XT, JBG-40XU, JBG-40XV, JBG-40XW, JBG-40XX, JBG-40XY, JBG-40XZ, JBG-40YA, JBG-40YB, JBG-40YC, JBG-40YD, JBG-40YE, JBG-40YF, JBG-40YG, JBG-40YH, JBG-40YI, JBG-40YJ, JBG-40YK, JBG-40YL, JBG-40YM, JBG-40YN, JBG-40YO, JBG-40YP, JBG-40YQ, JBG-40YR, JBG-40YS, JBG-40YT, JBG-40YU, JBG-40YV, JBG-40YW, JBG-40YX, JBG-40YY, JBG-40YZ, JBG-40ZA, JBG-40ZB, JBG-40ZC, JBG-40ZD, JBG-40ZE, JBG-40ZF, JBG-40ZG, JBG-40ZH, JBG-40ZI, JBG-40ZJ, JBG-40ZK, JBG-40ZL, JBG-40ZM, JBG-40ZN, JBG-40ZO, JBG-40ZP, JBG-40ZQ, JBG-40ZR, JBG-40ZS, JBG-40ZT, JBG-40ZU, JBG-40ZV, JBG-40ZW, JBG-40ZX, JBG-40ZY, JBG-40ZZ

DATE OF EXPIRE: 30/06/2021





**营业执照**  
(副本)  
统一社会信用代码 914301117700857925

名称 长沙湘佳金属材料有限公司  
类型 有限责任公司(自然人投资或控股)  
住所 长沙市雨花区人民东路46号铭诚大厦1605-1609房  
法定代表人 游炎明  
注册资本 伍佰万元整  
成立日期 2005年01月26日  
营业期限 2005年01月26日至 2055年01月25日  
经营范围 金属材料加工、销售;五金工具、农产品、建材、机电产品的销售;自营和代理各类商品和技术的进出口,但国家限定公司经营或禁止进出口的商品和技术除外。(涉及行政许可的凭许可证经营)



登记机关 长沙工商行政管理局  
2016年1月7日



**检验报告**  
TEST REPORT

**ISET s.r.l.**  
Istituto Servizi  
Europei TECNOLOGICI

Sette Legate s. r.l.  
Via Donatori di Sangue, 5 - 40024 Bologna (BO)  
Tel. +39 051 23751000  
info@iset.it  
www.iset.it

Cap. 500.000.000  
Cod. Fiscale 01554740101  
Reg. Imprese  
MI 0237099

**CERTIFICATE OF COMPLIANCE**  
Certificado de Conformidade - Сертификат соответствия - Konformitätserklärung

1) **APPLICANT:**  
Changsha Xiangjia Metal Material Trading Co., Ltd.  
Room 1605-1609, Mingcheng International Building,  
No. 46 Renmin East Road,  
Changsha, Hunan, China

2) **CERTIFICATE NO.:**  
IT031406JD160701S  
**TCF(S) NO.:**  
TCF(10)-237-MD

3) **WITH REFERENCE TO EC DIRECTIVE APPLIED:**  
Machinery Directive 2006/42/EC

4) **CERTIFICATION ISET MARK:**  

**HARMONIZED STANDARDS APPLIED:**  
EN ISO 12100:2010

5) **PRODUCT CHARACTERISTICS:** Rebar Coupler  
**MODELS:** Φ12, Φ14, Φ16, Φ18, Φ20, Φ22, Φ25, Φ28, Φ32, Φ36, Φ40, Φ50, Φ60, Φ70, Φ80, Φ90, Φ100, Φ110, Φ120, Φ130, Φ140, Φ150, Φ160, Φ180, Φ200, Φ220, Φ250, Φ280, Φ320, Φ360, Φ400, Φ450, Φ500, Φ550, Φ600, Φ650, Φ700, Φ750, Φ800, Φ850, Φ900, Φ950, Φ1000, Φ1100, Φ1200, Φ1300, Φ1400, Φ1500, Φ1600, Φ1800, Φ2000, Φ2200, Φ2500, Φ2800, Φ3200, Φ3600, Φ4000, Φ4500, Φ5000, Φ5500, Φ6000, Φ6500, Φ7000, Φ7500, Φ8000, Φ8500, Φ9000, Φ9500, Φ10000, Φ11000, Φ12000, Φ13000, Φ14000, Φ15000, Φ16000, Φ18000, Φ20000, Φ22000, Φ25000, Φ28000, Φ32000, Φ36000, Φ40000, Φ45000, Φ50000, Φ55000, Φ60000, Φ65000, Φ70000, Φ75000, Φ80000, Φ85000, Φ90000, Φ95000, Φ100000, Φ110000, Φ120000, Φ130000, Φ140000, Φ150000, Φ160000, Φ180000, Φ200000, Φ220000, Φ250000, Φ280000, Φ320000, Φ360000, Φ400000, Φ450000, Φ500000, Φ550000, Φ600000, Φ650000, Φ700000, Φ750000, Φ800000, Φ850000, Φ900000, Φ950000, Φ1000000, Φ1100000, Φ1200000, Φ1300000, Φ1400000, Φ1500000, Φ1600000, Φ1800000, Φ2000000, Φ2200000, Φ2500000, Φ2800000, Φ3200000, Φ3600000, Φ4000000, Φ4500000, Φ5000000, Φ5500000, Φ6000000, Φ6500000, Φ7000000, Φ7500000, Φ8000000, Φ8500000, Φ9000000, Φ9500000, Φ10000000, Φ11000000, Φ12000000, Φ13000000, Φ14000000, Φ15000000, Φ16000000, Φ18000000, Φ20000000, Φ22000000, Φ25000000, Φ28000000, Φ32000000, Φ36000000, Φ40000000, Φ45000000, Φ50000000, Φ55000000, Φ60000000, Φ65000000, Φ70000000, Φ75000000, Φ80000000, Φ85000000, Φ90000000, Φ95000000, Φ100000000, Φ110000000, Φ120000000, Φ130000000, Φ140000000, Φ150000000, Φ160000000, Φ180000000, Φ200000000, Φ220000000, Φ250000000, Φ280000000, Φ320000000, Φ360000000, Φ400000000, Φ450000000, Φ500000000, Φ550000000, Φ600000000, Φ650000000, Φ700000000, Φ750000000, Φ800000000, Φ850000000, Φ900000000, Φ950000000, Φ1000000000, Φ1100000000, Φ1200000000, Φ1300000000, Φ1400000000, Φ1500000000, Φ1600000000, Φ1800000000, Φ2000000000, Φ2200000000, Φ2500000000, Φ2800000000, Φ3200000000, Φ3600000000, Φ4000000000, Φ4500000000, Φ5000000000, Φ5500000000, Φ6000000000, Φ6500000000, Φ7000000000, Φ7500000000, Φ8000000000, Φ8500000000, Φ9000000000, Φ9500000000, Φ10000000000, Φ11000000000, Φ12000000000, Φ13000000000, Φ14000000000, Φ15000000000, Φ16000000000, Φ18000000000, Φ20000000000, Φ22000000000, Φ25000000000, Φ28000000000, Φ32000000000, Φ36000000000, Φ40000000000, Φ45000000000, Φ50000000000, Φ55000000000, Φ60000000000, Φ65000000000, Φ70000000000, Φ75000000000, Φ80000000000, Φ85000000000, Φ90000000000, Φ95000000000, Φ100000000000, Φ110000000000, Φ120000000000, Φ130000000000, Φ140000000000, Φ150000000000, Φ160000000000, Φ180000000000, Φ200000000000, Φ220000000000, Φ250000000000, Φ280000000000, Φ320000000000, Φ360000000000, Φ400000000000, Φ450000000000, Φ500000000000, Φ550000000000, Φ600000000000, Φ650000000000, Φ700000000000, Φ750000000000, Φ800000000000, Φ850000000000, Φ900000000000, Φ950000000000, Φ1000000000000, Φ1100000000000, Φ1200000000000, Φ1300000000000, Φ1400000000000, Φ1500000000000, Φ1600000000000, Φ1800000000000, Φ2000000000000, Φ2200000000000, Φ2500000000000, Φ2800000000000, Φ3200000000000, Φ3600000000000, Φ4000000000000, Φ4500000000000, Φ5000000000000, Φ5500000000000, Φ6000000000000, Φ6500000000000, Φ7000000000000, Φ7500000000000, Φ8000000000000, Φ8500000000000, Φ9000000000000, Φ9500000000000, Φ10000000000000, Φ11000000000000, Φ12000000000000, Φ13000000000000, Φ14000000000000, Φ15000000000000, Φ16000000000000, Φ18000000000000, Φ20000000000000, Φ22000000000000, Φ25000000000000, Φ28000000000000, Φ32000000000000, Φ36000000000000, Φ40000000000000, Φ45000000000000, Φ50000000000000, Φ55000000000000, Φ60000000000000, Φ65000000000000, Φ70000000000000, Φ75000000000000, Φ80000000000000, Φ85000000000000, Φ90000000000000, Φ95000000000000, Φ100000000000000, Φ110000000000000, Φ120000000000000, Φ130000000000000, Φ140000000000000, Φ150000000000000, Φ160000000000000, Φ180000000000000, Φ200000000000000, Φ220000000000000, Φ250000000000000, Φ280000000000000, Φ320000000000000, Φ360000000000000, Φ400000000000000, Φ450000000000000, Φ500000000000000, Φ550000000000000, Φ600000000000000, Φ650000000000000, Φ700000000000000, Φ750000000000000, Φ800000000000000, Φ850000000000000, Φ900000000000000, Φ950000000000000, Φ1000000000000000, Φ1100000000000000, Φ1200000000000000, Φ1300000000000000, Φ1400000000000000, Φ1500000000000000, Φ1600000000000000, Φ1800000000000000, Φ2000000000000000, Φ2200000000000000, Φ2500000000000000, Φ2800000000000000, Φ3200000000000000, Φ3600000000000000, Φ4000000000000000, Φ4500000000000000, Φ5000000000000000, Φ5500000000000000, Φ6000000000000000, Φ6500000000000000, Φ7000000000000000, Φ7500000000000000, Φ8000000000000000, Φ8500000000000000, Φ9000000000000000, Φ9500000000000000, Φ10000000000000000, Φ11000000000000000, Φ12000000000000000, Φ13000000000000000, Φ14000000000000000, Φ15000000000000000, Φ16000000000000000, Φ18000000000000000, Φ20000000000000000, Φ22000000000000000, Φ25000000000000000, Φ28000000000000000, Φ32000000000000000, Φ36000000000000000, Φ40000000000000000, Φ45000000000000000, Φ50000000000000000, Φ55000000000000000, Φ60000000000000000, Φ65000000000000000, Φ70000000000000000, Φ75000000000000000, Φ80000000000000000, Φ85000000000000000, Φ90000000000000000, Φ95000000000000000, Φ100000000000000000, Φ110000000000000000, Φ120000000000000000, Φ130000000000000000, Φ140000000000000000, Φ150000000000000000, Φ160000000000000000, Φ180000000000000000, Φ200000000000000000, Φ220000000000000000, Φ250000000000000000, Φ280000000000000000, Φ320000000000000000, Φ360000000000000000, Φ400000000000

# Why CHOOSE ADTO MECHANICAL SPLICE?

ADTO Rebar Couplers are parallel threaded Mechanical splicing system for reinforcing bars diameter 16-40mm and are designed to provide full tensile strength.

Due to the growing technical challenges faced in today's construction industry, traditional methods for connecting rebar, it provides such as lapping or welding. It is no longer the best method to connect rebar

More and more construction codes are specifying a mechanical coupler because it provides better structural integrity while minimizing costs. Some of the benefits of using a ADTO mechanical coupler.

ADTO Rebar Couplers are manufactured in compliance with BS8810, ACI318, DIN1045 and other international Standard.

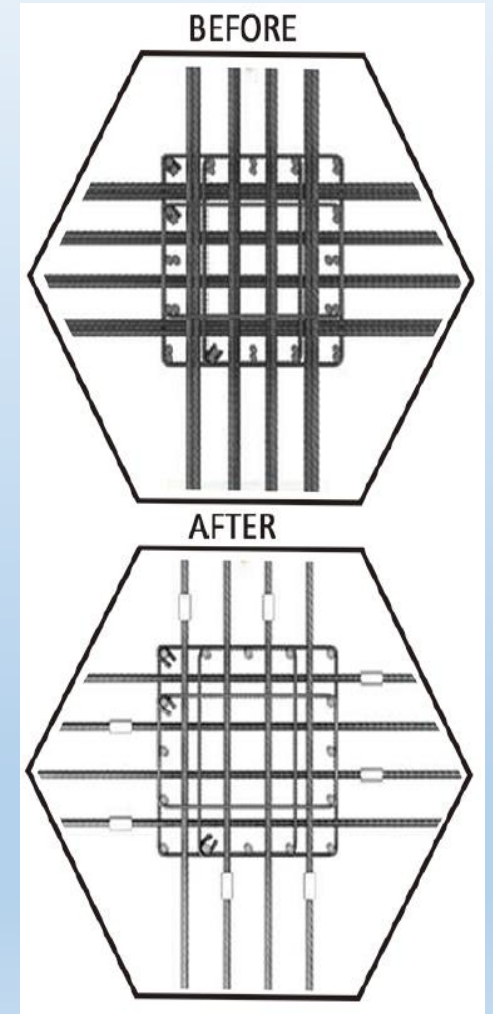

# 100% Bar Break Performance

ADTO Bar splice is a parallel thread mechanical splicing system designed for the connection of concrete reinforcing bars from 16-40.

## Main Features:

1. More reliable and more structural integrity than lap splices because they are no longer rely on the concrete for load transfer
2. Lowers the risk of rock and air pockets by reducing rebar congestion efficient and easy design options result in smaller and stronger columns with the maximum amount of useful area.
3. Avoids dilling or cutting forms, especially in crane, elevator opening, and stairwells.
4. Install easily and quickly.
5. Reduces the amount of rebar, which reduces the labor and crane time-improving and the construction schedule.
6. No lapping length necessary-reduces inventory
7. Lower cost
8. Better splice inspection – lowers quality control costs
9. Allows for same line splicing
10. No staggered splice
11. Minimizes rebar waste

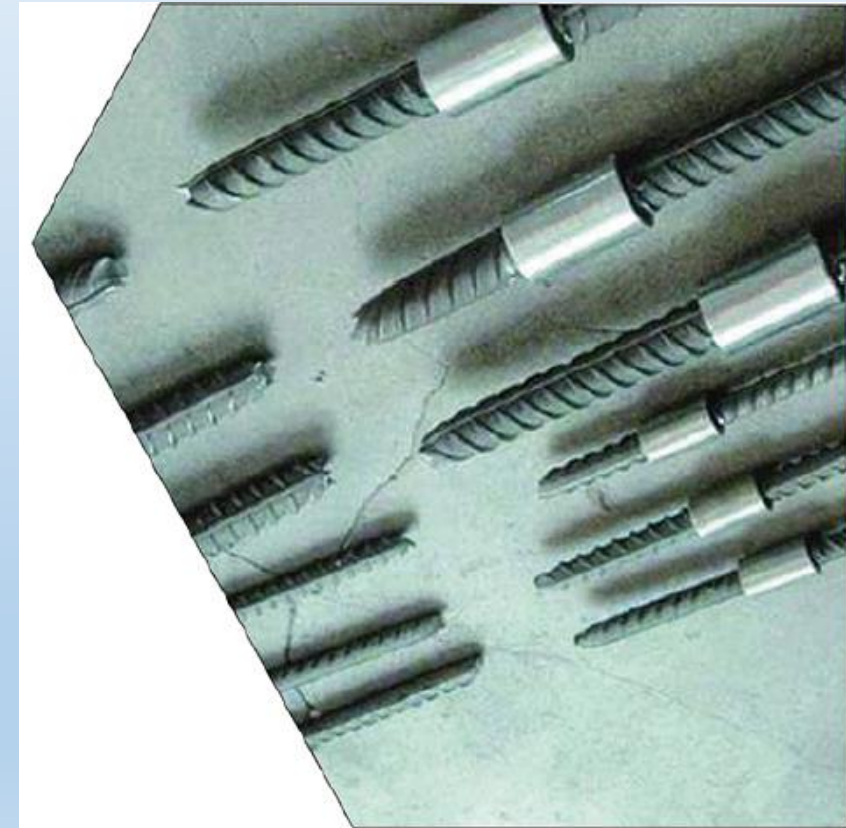



# Splicing Coupler Features

1. Material ( threaded rebar coupler ): #45C round bar steel, structural seamless pipe

45#C Mechanical Property	
Item	Performance Index
Yield Strength (Mpa)	>=355Mpa
Tensile Strength (Mpa)	>=600 Mpa
Elongation(%)	>=16%
Hardness(HRBW)	≤ 197 HBS

Material (cold extraction rebar coupler) : 10#/20# structural carbon steel; or Q235 /Q275

Cold Extrusion Rebar Coupler Material Mechanical Property	
Item	Performance Index
Yield Strength (Mpa)	205-350Mpa
Tensile Strength (Mpa)	335-500 Mpa
Elongation(%)	≥20
Hardness (HRBW)	50-80HBS

**Degree:** 60/75° thread angle

**Standard:** BS 4449, B500,JG/T 163-2013, HRB 400 , HRB 500  
BS8810, ACI318, DIN1045

# Rebar Coupler Category

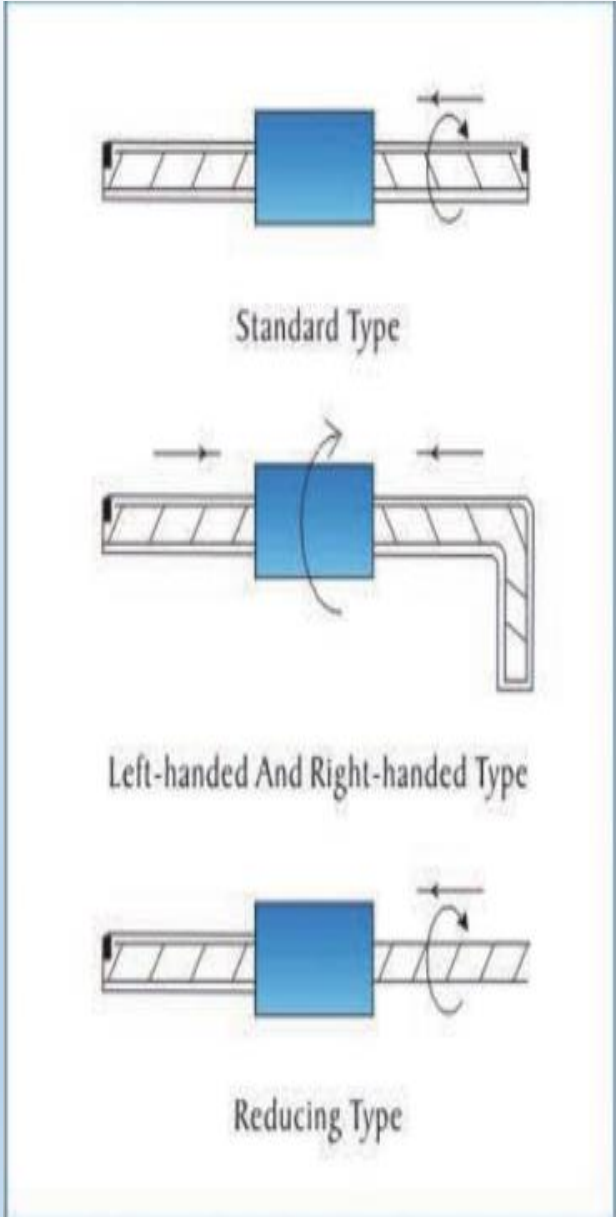

# MECHANICAL PROPERTIES OF STEEL REBAR

Standard	Grade	Nominal Diameter mm	Yield Strength MPa (min)	TENSILE Strength Mpa(min)	Tensile to Yield Ratio (min)	Elogation in 200mm%(min)	Elongation Grade (AS)%(Min)	Agt % (min)
ASTM A615	40	<u>10</u> 14-18	280	420	N/A	<u>11</u> 12	N/A	N/A
	60	<u>10-19</u> <u>20-25</u> >25	420	620	N/A	<u>9</u> <u>8</u> 7	N/A	N/A
ASTM A615	460B	10-40	460	N/A	1.08	N/A	14	5
BS4449,2005	B500B	10-32	500	N/A	1.08	N/A	N/A	5
GCC Standard GSO/ISO	4B400BR B400BWR O	10-40	400	N/A	1.08	N/A	14	5
	B500BR B500BWR	10-32	500	N/A	1.08	N/A	14	5

# CHEMICAL COMPOSITION OF STEEL REBARS

Standard	Grade	Chemical Composition % ( Maximum)							
		C	Si	Mn	S	P	N	Cu	C.E.V.
ASTM A615	60	.....	....	....	....	0.060	....	....	....
BS4449 1997	460B	0.250	....	....	0.050	0.050	0.012	....	0.510
BS4449 :2005	B500B	0.220	....	....	0.050	0.050	....	0.800	0.500
GCC Standard GSO6/ISO 6935-2/2007	B400BR/B500BR B400BWR B500BWR	.....	.....	....	0.600	0.600	....	.....	.....
		0.220	0.600	1.600	0.050	0.050	0.012	.....	0.500



# TYPE OF COUPLER



UPSETING COUPLER



REBAR ROLLING  
COUPLER



HYDRULIC COUPLER



SCREW COUPLER



EPOXY COUPLER



GROUT SIEVE  
COUPLER



12REBAR COUPLER



ONE TOUCH COUPLER

# Splicing Coupler Size

Size	Out Diameter MM	Length MM	Pitch
D16	24	38	2.5
D18	27	43	2.5
D20	30	46	2.5
D25	32.5	51	3.0
D28	37	58	3.0
D30	41.5	63	3.0
D32	47.5	71	3.0
D36	53	78	3.0
D40	59	88	3.0



GB Standard Rebar Coupler

Size	Out Diameter MM	Length MM	Pitch
D16	22	61	2.0
D18	27	71	2.0
D20	27	88	2.0
D25	33	91	2.0
D28	33	96	2.0
D30	37	101	2.0
D32	42	107	2.0
D36	46	121	2.0
D40	55	138	2.0



Taper Rebar Coupler

Size	Out Diameter MM	Length MM	Rebar size
GQTQ12	44	250	Dia12
GQTQ14	46	280	Dia14
GQTQ16	48	315	Dia16
GQTQ18	50	345	Dia18
GQTQ20	52	375	Dia20
GQTQ22	54	410	Dia22
GQTQ25	58	455	Dia25
GQTQ28	62	505	Dia28
GQTQ32	68	570	Dia32
GQTQ36	74	635	Dia36
GQTQ40	82	705	Dia40



Grouting Rebar Coupler

Size	Out Diameter MM	Length MM	Rebar size
JY4 16	30	110	Dia12
JY4 18	34	118	Dia14
JY4 20	36	120	Dia16
JY4 22	40	132	Dia18
JY4 25	45	150	Dia20
JY4 28	50	168	Dia22
JY4 32	56	192	Dia25



Cold Extrusion Rebar Coupler



# Production line

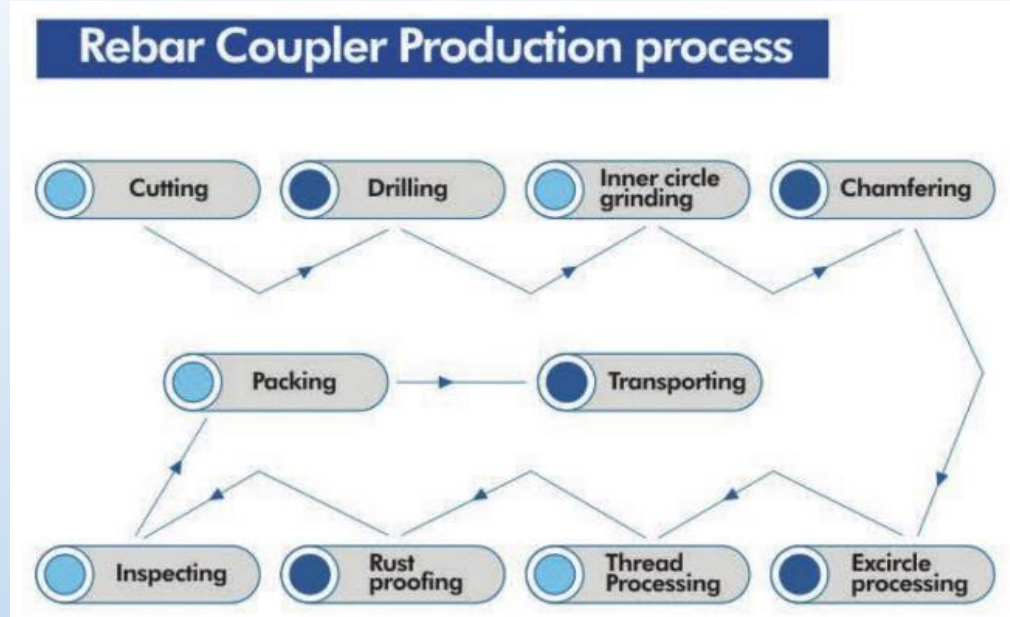

# Testing & Packing



# Rebar Splicing Equipment



Thread rolling machine	Main Technical Parameters			
	Type	45E	65E	50E
	Rebar Dia	14mm-32mm	14mm-40mm	14mm-40mm
	Motor Power	4000w	4000w	4000w
	Voltage	380Volt 50HZ	380Volt 50HZ	380Volt 50HZ
	Spindle speed	1450 RPM		
	Maximum thread length	100mm	200mm	100mm
	Thread Angle	60/75	60/75	60/75
	Weight	450KG/SET	470KG/SET	520KG/SET
	Working Life	1-2 Years	3-5 Years	7 years



- 1. This machine can process standard thread coupler and also can process the right and left hand coupler, rib and thread at one time, and the tooth fullness, size accurate
- 2. Adopting unique spiral angle lifting technology, convenient and rapid for thread tightening ,improving working efficiency
- 3. Optimized adjusting the size of rolling threads at one time, no replacement of tool rests
- 4. Adopting eccentric shaft design, inter tooth plate adjustment ,high machining efficiency
- 5. Three points in one time, high concentricity , high stability
- 6. Rebar realizes easy feeding, automatic return thread rolling of the machine tools ,daily production of 600-1000pcs of thread head every day



# Rebar Splicing Equipment



Taper thread machine

## Features

- 1. Structure reasonable
- 2. Portable and flexible
- 3. Easy Operation
- 4. High Efficiency



Tamper thread roller machine	Main Technical Parameters	
	Maximum size of rebar which can be used with this machine	16mm-32mm
	Motor Power	4000w
	Voltage	380Volt 50HZ
	Spindle speed	50/mius
	Rebar length	>=300mm
	Dimension	1200*700*1100
	Weight	400KG /SET

# Rebar Splicing Equipment



Cold Extrusion Machine is used to process the rebar end, No Specific requirement on the weld ability of the rebar

## The Features

- 1.Strong intensity connector, stable and reliable
- 2.No specific requirements on the weld ability of the rebar
- 3.Not limited by power capacity ,has flexible structure and and suitable for operation on several machine
4. About ten times faster than ordinary welding
5. No flammable gases, not affected by rainy or cold weather
6. No Professional and experienced worker needed, able to connect changed steel bar of different diamaters
7. Relieve congestion of the connecting point ,facilitated concrete pouring
8. The technology is assessed by the Ministry of Construction as “world advanced ,high quality , high efficiency, safe ,and economical thick diameter distorted steel bar connection technology which can be widely used in the construction industry”

Cold extrusion machine  
Main Technical Parameters

High-pressure pump	Maximum size of rebar which can be used with this machine	16mm-40mm
	Operational stroke:	45mm
	Voltage	380Volt 50HZ
	Powder	4000w
	Rated pressure	80MPA
	Dimension	790*540*785
	Capacity of tank:	30L
	weight	96kg/set
Hydraulic tool	Rated pressure	80Mpa
	Rated press force	900KN
	Weight	34kg
	Size	160mm*500
Pipe	length	5m
Mold	size	12/14/16/18/20/22/25/28/32/36/40

# Rebar Splicing Equipment



Upsetting forging machine	Main Technical Parameters	
	Maximum size of rebar which can be used with this machine	16mm-32mm
	Total power of electric (al) motor	7500w
	Voltage	380Volt 50HZ
	Maximum working pressure	<=25MPA
	Dimension	1550*570*1100mm
	Weight	950KG /SET

## Specifications

1. Use upset forging machine to forging rebar coupler
2. Use rebar thread cutting machine to process thread
3. Use rebar coupler to joint two threaded ends of rebar

## Advantages:

- 1 The tensile strength can be reach 1.1times of steel bar, make sure 100% bar break.
2. Easy operation
3. High efficiency, forging and threading one rebar end only cost no more than one minute.



# Rebar Splicing Equipment



Cold Forged Machine	Main Technical Parameters	
	Maximum size of rebar which can be used with this machine	Φ14mm~Φ40mm
	Power rating	4000w
	Voltage	380Volt 60HZ/50HZ
	Thread length	Maximum 100mm
	Dimension	1450*700*1600mm
	Weight	750KG /SET
Thread Cutting Machine		
	Maximum size of rebar which can be used with this machine	Φ14mm~Φ40mm
	Power rating	4000w
	Thread Angle	60/75
	Thread Pitch	2MM;2.5MM;3MM;3.5MM
	Voltage	380Volt 60HZ/50HZ
	Thread length	Maximum 100mm
	Dimension	1450*700*1600mm
	Weight	750KG /SET



# Rebar Splicing Equipment



Rebar Bend Machine

Rebar bend machine  
GW50

Main Technical Parameters	
Maximum size of rebar which can be used with this machine	≤Φ40MM
Power rating	4000w
Voltage	380Volt 50HZ
Dimension	1030*730*770mm
Weight	280KG /SET



Full-automation threading rebar machine

Rebar bend machine  
GW40

Main Technical Parameters	
Maximum size of rebar which can be used with this machine	≤Φ40MM
Power rating	4000w
Voltage	380Volt 50HZ
Dimension	930mm*730mm*730mm
Weight	350kg(+/-5)



Grouting machine

# Accessories



**BLADE**



**Spanner**



**Eccentric Shaft**



**Thread Head**

**Thread roller**



**Torque wrench**



# Project



Kuwait University Town



Olaya Tower (Saudi Arabia)



South Korea Incheon Airport



Vladivostok Cross-sea Bridge



Sri Lanka National Art Theatre